

NOTICE!!

These documents have been scanned!

Do not place un-scanned documents beneath this notice!

Do not remove this notice from this file!

GPO Jacket No. 560-102
Print Order 61540
Rise Business Services, LLC
Job=AZ15 5/1/2019



Box Number= AZ15014



Claim Begin-End: AMC440067-AMC440067

1 Initial Receipt



AZ15014-32

AMC439776-AMC440076

AMC #

DATE CLOSED

ADJ INITIAL

REMARKS

United States Department of the Interior
Bureau of Land Management
 DIV OF LANDS, MINRLS & ENERGY
 ONE N CENTRAL AVE
 PHOENIX, AZ 85004 -4427
 Phone: 602-417-9200

Receipt

No: 3694890

Transaction #: 3799526	
Date of Transaction: 11/08/2016	
CUSTOMER:	
JOHN HIGGINBOTHAM 161 RED CEDAR DR LEVITTOWN, PA 19055-1445 US	

ENTERED
 NOV 09 2016
 BY: *RAM*

LINE #	QTY	DESCRIPTION	REMARKS	UNIT PRICE	TOTAL
1	1.00	LOCATABLE MINERALS / MINING CLAIMS-NEW, UNADJUD, ONE OR MORE AUTH NOS / NEW MINING CLAIMS LOCATION FEE CASES: AMC440067/\$37.00		- n/a -	37.00
2	1.00	LOCATABLE MINERALS / MINING CLAIMS-NEW, UNADJUD, ONE OR MORE AUTH NOS / NEW MINING CLAIM PROCESSING FEE CASES: AMC440067/\$20.00		- n/a -	20.00
3	1.00	LOCATABLE MINERALS / MINING CLAIMS-NEW, UNADJUD, ONE OR MORE AUTH NOS / NEW MINING CLAIMS MAINTENANCE FEE CASES: AMC440067/\$155.00		- n/a -	155.00
4	1.00	LOCATABLE MINERALS / MINING CLAIMS-NOT NEW-UNADJUD, ONE AUTH NO. ONLY / MINING CLAIM MONEY RECEIVED CASES: AMC440067/\$155.00	NEW ASSOC PLACER	- n/a -	155.00
TOTAL:					\$367.00

PAYMENT INFORMATION			
NOTE: Items will appear on credit card statement as "Bureau of Land Mgmt CO".			
1	AMOUNT:	57.00	POSTMARKED: N/A
	TYPE:	CREDIT CARD	RECEIVED: 11/08/2016
	NAME:		
	CARD NO:	XXXXXXXXXXXX6656	AUTH CODE: 157877
	NAME ON CARD:	THEODORE S BIGELOW	
	EXPIRES:	02/2018	

	SIGNATURE:			
2	AMOUNT:	310.00	POSTMARKED:	N/A
	TYPE:	CHECK	RECEIVED:	11/08/2016
	CHECK NO:	565		
	NAME:	HIGGINBOTHAM, JOHN 161 RED CEDAR DR LEVITTOWN PA 19055-1445 US		

REMARKS	

This receipt was generated by the automated BLM Collections and Billing System and is a paper representation of a portion of the official electronic record contained therein.

NOTICE!!

These documents have been scanned!

Do not place un-scanned documents beneath this notice!

Do not remove this notice from this file!

GPO Jacket No. 560-102
Print Order 61540
Rise Business Services, LLC
Job=AZ15 5/1/2019



Box Number= AZ15014



Claim Begin-End: AMC440067-AMC440067

2 Correspondence



AZ15014-32

AMC439776-AMC440076

**NO
DOCUMENTS
FOUND**

NO DOCUMENTS FOUND
NO DOCUMENTS FOUND

NOTICE!!

These documents have been scanned!

Do not place un-scanned documents beneath this notice!

Do not remove this notice from this file!

GPO Jacket No. 560-102
Print Order 61540
Rise Business Services, LLC
Job=AZ15 5/1/2019



Box Number= AZ15014



Claim Begin-End: AMC440067-AMC440067

3 Transfers



AZ15014-32

AMC439776-AMC440076

**NO
DOCUMENTS
FOUND**

NO DOCUMENTS FOUND
NO DOCUMENTS FOUND

NOTICE!!

These documents have been scanned!

Do not place un-scanned documents beneath this notice!

Do not remove this notice from this file!

GPO Jacket No. 560-102
Print Order 61540
Rise Business Services, LLC
Job=AZ15 5/1/2019



Box Number= AZ15014



Claim Begin-End: AMC440067-AMC440067

4 Annual Filings



AZ15014-32

AMC439776-AMC440076

DEPARTMENT OF THE INTERIOR
BUREAU OF LAND MANAGEMENT
MINING CLAIMS

Run Date/Time: 9/11/2018

MC Maintenance Fees Paid Through the BLM Pay Portal
(by Date Paid)

Page 287 Of 723

CBS Receipt: 4246742

Printed For Lead File # AMC440067

Agency Tracking ID: 1535371824

Assessment Year: 2019

Number of BLM Serial Nr: 1

Paid On: 8/27/2018

Total Amount Paid: \$310.00

Claim Name	BLM Serial No	Lead File No	Amount Paid
RAINBOW'S END NO 11	AMC440067	AMC440067	\$310.00

United States Department of the Interior

Bureau of Land Management
 BUSINESS & SUPPORT SVCS DIV
 ONE N CENTRAL AVE SUITE 800
 PHOENIX, AZ 85004 -4427
 Phone: 602-417-9200

Receipt

No: 4246742

Transaction #: 4362205	
Date of Transaction: 08/27/2018	
CUSTOMER:	
JOHN HIGGINBOTHAM 2369 UNION RD. PHILADELPHIA,MS 39350 US	

LINE #	QTY	DESCRIPTION	REMARKS	UNIT PRICE	TOTAL
1	1.00	LOCATABLE MINERALS / MINING CLAIMS-NOT NEW-UNADJUD,ONE AUTH NO. ONLY / MINING CLAIM MONEY RECEIVED CASES: AMC440067/\$310.00		- n/a -	310.00
TOTAL:					\$310.00

PAYMENT INFORMATION					
NOTE: Items will appear on credit card statement as "BLM O Mining Claim".					
1	AMOUNT:	310.00	POSTMARKED:	N/A	
	TYPE:	CREDIT CARD	RECEIVED:	08/27/2018	
	NAME:	JOHN HIGGINBOTHAM 2369 UNION RD. PHILADELPHIA MS 39350 US			
	CARD NO:	XXXXXXXXXXXX9931	AUTH CODE:	09715D	
	NAME ON CARD:	JOHN HIGGINBOTHAM			
	SIGNATURE:				

REMARKS

This receipt was generated by the automated BLM Collections and Billing System and is a paper representation of a portion of the official electronic record contained therein.

Run Date: 08/09/17

Run Time: 02:20 PM

**DEPARTMENT OF THE INTERIOR
BUREAU OF LAND MANAGEMENT
MINING CLAIMS**

MC Maintenance Fees Paid Through the BLM Pay Portal

CBS Receipt: 3925667

Printed For Lead File # AMC440067

Agency Tracking ID: 1502129958

Assessment Year: 2018

Number of BLM Serial Nr: 1

Paid On: 08/07/2017

Total Amount Paid: \$310.00

Claim Name	BLM Serial No	Lead File No	Amount Paid
RAINBOW'S END NO 11	AMC440067	AMC440067	\$310.00

**United States Department of the Interior
Bureau of Land Management
BUSINESS & SUPPORT SVCS DIV
ONE N CENTRAL AVE SUITE 800
PHOENIX, AZ 85004 -4427
Phone: 602-417-9200**

Receipt

No: 3925667

Transaction #: 4035202	
Date of Transaction: 08/07/2017	
CUSTOMER:	
JOHN HIGGINBOTHAM 2369 UNION RD. PHILADELPHIA,MS 39350 US	

LINE #	QTY	DESCRIPTION	REMARKS	UNIT PRICE	TOTAL
1	1.00	LOCATABLE MINERALS / MINING CLAIMS- NOT NEW-UNADJUD,ONE AUTH NO. ONLY / MINING CLAIM MONEY RECEIVED CASES: AMC440067/\$310.00		- n/a -	310.00
TOTAL:					\$310.00

PAYMENT INFORMATION					
NOTE: Items will appear on credit card statement as "BLM O Mining Claim".					
1	AMOUNT:	310.00	POSTMARKED:	N/A	
	TYPE:	CREDIT CARD	RECEIVED:	08/07/2017	
	NAME:	JOHN HIGGINBOTHAM 2369 UNION RD. PHILADELPHIA MS 39350 US			
	CARD NO:	XXXXXXXXXXXX9931	AUTH CODE:	04299D	
	NAME ON CARD:	JOHN HIGGINBOTHAM			
	EXPIRES:	03/2022			
	SIGNATURE:				

REMARKS

This receipt was generated by the automated BLM Collections and Billing System and is a paper representation of a portion of the official electronic record contained therein.

NOTICE!!

These documents have been scanned!

Do not place un-scanned documents beneath this notice!

Do not remove this notice from this file!

GPO Jacket No. 560-102
Print Order 61540
Rise Business Services, LLC
Job=AZ15 5/1/2019

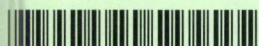

Box Number= AZ15014



Claim Begin-End: AMC440067-AMC440067

5 Miscellaneous



AZ15014-32

AMC439776-AMC440076

**NO
DOCUMENTS
FOUND**

NO DOCUMENTS FOUND
NO DOCUMENTS FOUND

NOTICE!!

These documents have been scanned!

Do not place un-scanned documents beneath this notice!

Do not remove this notice from this file!

GPO Jacket No. 560-102
Print Order 61540
Rise Business Services, LLC
Job=AZ15 5/1/2019



Box Number= AZ15014



Claim Begin-End: AMC440067-AMC440067

6 Location Notices-Amendments and Supporting Documents



AZ15014-32

AMC439776-AMC440076

MINING CLAIM STATUS REPORT

Data Entered: 11/09/16 RAm

MTP Checked By: 11/09/16 RAm
GEO Checked By: 11/09/16 RAm

LEAD SERIAL NUMBER: AMC 440067 ru AMC _____

NUMBER OF CLAIMS & TYPE:

LODE

PLACER
1 _____
ASSOCIATION PLACER

MILL SITE

TUNNEL SITE

CHARGES:

Location Fee @ \$37 = \$ 37.00
Processing Fee @ \$20 = \$ 20.00
Maintenance Fee @ \$155 = \$ 155.00
Add'l Maint Fee for Assoc Placer = \$ 155.00
SUBTOTAL \$ 367.00
Other Fees \$ _____
Other Fees \$ _____
TOTAL \$ 367.00

TOTAL ACREAGE: 39.09 Per Claim
(Placer Only)

NUMBER OF LOCATORS: 2

DOCUMENTS RECEIVED VIA: Over-the-Counter [] Mail [] **TIMELY FILED:** Yes [] No []

LEGAL DESCRIPTION: T 7N R 3W SEC 7
T _____ R _____ SEC _____
T _____ R _____ SEC _____
T _____ R _____ SEC _____
T _____ R _____ SEC _____

BLM [] FOREST SERVICE [] _____ SUBJ TO PL 359: Yes [] No []
WILDERNESS AREA [] _____

SPLIT ESTATE: N/A [] SX [] PX [] OTHER [] _____
SRHA [] Was proper Notice filed if located on SHRA Land? Yes [] No []

RECONVEYED MINERALS ON BLM LAND REQUIRE OPENING ORDER FROM 1944 TO 1993:
Open to Entry On _____ N/A []

COMMENTS/STATUS: VOID [] PARTIALLY VOID [] PVT MINERALS [] WITHDRAWN LANDS []
OTHER [] _____

[] Claimant acknowledges that portions of the following claim(s) site(s) may be void or voidable.

Printed Name of Claimant _____ Signature of Claimant _____

*****FINAL ADJUDICATION*****

DATE 6/29/2017 INITIALS JM

AM0440067

LOCATION NOTICE FOR PLACER MINING CLAIM

NOTICE IS HEREBY GIVEN that the Rainbow's End #11 placer mining claim has been located by John Higginbotham & Gilbert Higginbotham
161 Red Cedar DR.
Levittown, PA 19055

The general course of this claim is Rectangular and it is situated in Maricopa County(ies), Arizona.

This claim is 1,320 feet in length and 1,290 feet in width. This claim runs from the location monument on which the location notice is posted approximately 1,320 feet in a Southerly direction to the South end line and 1,290 feet in a Westerly direction to the West end line. This claim is marked by four monuments, one at each corner of the claim.

The location monument on which this notice is posted is situated within Section 7, Township 7 N, Range 3 W, Gila Salt River Base and Meridian, Arizona. This claim encompasses portions of the following legal subdivision(s) if located by legal subdivision or the following quarter section(s), Section(s), Township(s), and Range(s): Survey Lot 3 (37.65 Acres),
Section 7, T7N R3W, Gila Salt River Base and Meridian, Arizona.

The locality of this claim with reference to some natural object or permanent monument and additional information (if any) concerning its locality are as follows: That 37.65 acres of
which the Southwest Corner is located 1,320 Ft. North of the Southwest
Corner of Section 7, T7N R3W, GSRB&M, AZ.

DATED AND POSTED on the ground this 2nd day of September, 2016.

LOCATOR(s) [Signature]
John Higginbotham

BLM DATE STAMP:
PHOENIX, ARIZONA
2016 NOV - 8 - 11 49
RECEIVED
BLM AZ STATE OFFICE

AMC140067

BLM DATE STAMP:

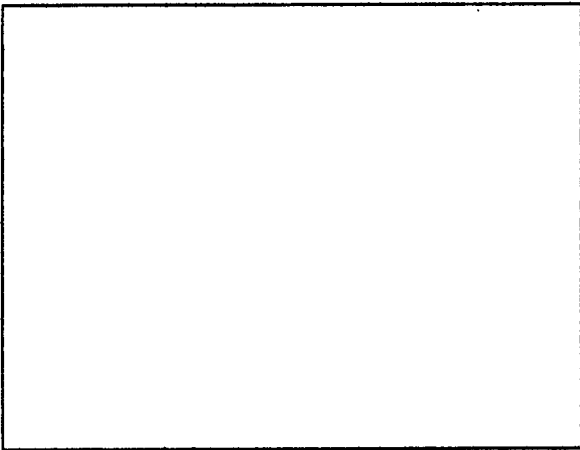

CLAIM MAP



Lode () Placer ()

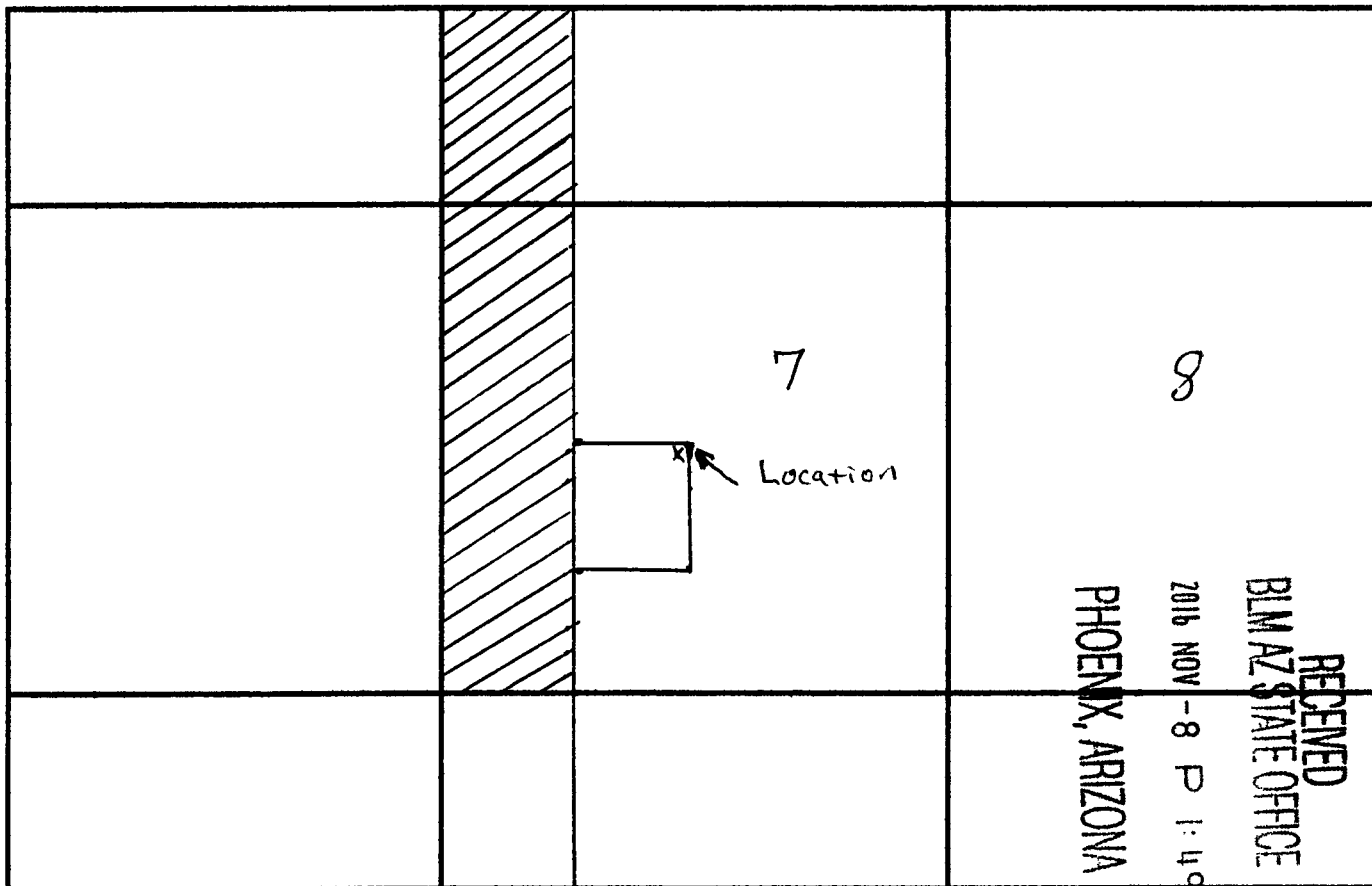

Scale: 1" = _____

1. The above map depicts the Rainbow's End #1 mining claim, which is located in the Survey Lot 3 of Section(s) 7, Township 7 N, Range 3 W, Gila and Salt River Base and Meridian, Maricopa County Arizona.

2. The type of corner and location monuments used are as follows: _____
1.5" x 4' Capped P.V.C.

3. The bearings and distances in degrees and feet between claim corners are as depicted on the map.

NOTE: DRAWING NOT TO SCALE

AMC140067

**DEPARTMENT OF INTERIOR
BUREAU OF LAND MANAGEMENT**

Input Parameters for Geographic Report with Land

System Id = CR

Admin State = AZ

Geo State =

Casetype Begins With

Case Disp Txt = AUTHORIZED, CANCELLED, EXPIRED, PENDING, REJECTED, RELINQUISHED, WITHDRAWN

Mer Twp Rng =

Section =

Mtrs = 14 0070N 0030W 007, 14 0070N 0030W 999

Commodity =

Commodity Txt =

Pending Org =

Pend Org Decode =

Total Rows Returned: 2

RUN TIME: 11:02 AM

Adm State: AZ

UNITED STATES DEPARTMENT OF INTERIOR
BUREAU OF LAND MANAGEMENT
GEOGRAPHIC REPORT WITH LAND
Sorted by Serial Number

RUN DATE: 11/09/2016
Page 1 of 1

Serial Number: AZA 031568
Total Case Acres: 1.000

<u>Casetype</u>	<u>Case Disp</u>				<u>Sect</u>	<u>Sur Typ</u>	<u>Sur Num</u>	<u>Suff</u>	<u>Subdivision</u>	<u>Act Pend</u>
293200	EXPIRED	14	0070N	0030W	007	FF			PORTION OF;	

Serial Number: AZA 035151
Total Case Acres: 1.000

<u>Casetype</u>	<u>Case Disp</u>				<u>Sect</u>	<u>Sur Typ</u>	<u>Sur Num</u>	<u>Suff</u>	<u>Subdivision</u>	<u>Act Pend</u>
293200	PENDING	14	0070N	0030W	007	FF			PORTION OF;	

